

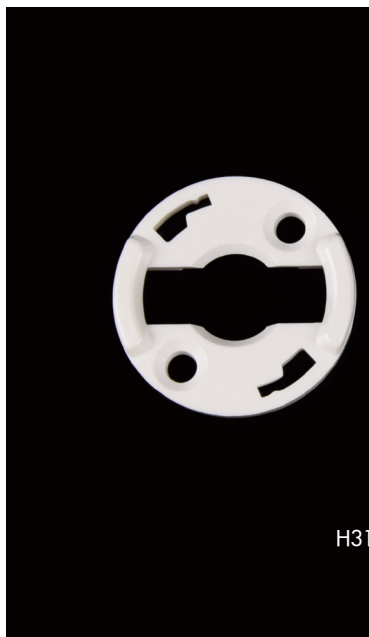

规格/TECHNICAL SPECIFICATIONS

型号/MODEL NUMBER:	I LENS141-COB28-50-H
透镜尺寸/LENS DIMENSIONS:	Φ28.0*16.5MM
支架尺寸/HOLDER DIMENSIONS:	Φ28.0*19.1MM
定位方式/FASTENING:	锁螺丝/Screw
是否符合ROHS/ROHS COMPLIANT:	是/YES



Holder Part No./支架零件号	Colour /颜色	Specification/规格	Matched led/匹配光源	Fastening/固定
H318M	Black/黑色		/	Clips 卡扣
H319M	White/白色		*Holder matched leds/支架匹配光源: CREE: 13xx Citizen:CLU700/CLU026/CLU027/CLL020 Luminus:CXM-3/CXM-4/CXM-6/CXM-9 Bridgelux :V3/V4/V6/V8/V4-HD/V6-HD	Screw 锁螺丝

说明/CHARACTERISTIC:

- 透镜有多种不同的配光角度。
The lens have multiple types beam angles.
- 不同的支架来匹配不同LED, 锁螺丝定位安装。
With different types brackets to match different leds, Screw positioning.
- 兼容多种灯珠。
Compatible with various led beads.
- 适用于室内照明。
Suitable for indoor lighting.
- 与市面上同类镜头相比, 光效更好, 光斑更漂亮, 兼容性更好, 特别是非常低的炫光值。
Compared with similar type lenses on the market,with higher efficiency,more beautiful spot and better compatibility.
Anti-glare lens with very low UGR

I LENS141-COB28-50-H

实测配光/OPTICAL RESULTS (PMMA)

LED:Bridgelux LES 4MM
半角(50%)/FWHM:42.5°
全角(10%)/FWTM:65.3°
光效/Efficiency:76.59%
眩光值/UGR:15.3
灯光颜色/Light colour: 白色/White

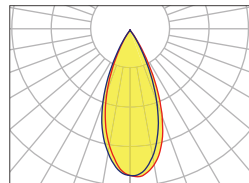

LED:Bridgelux LES 6MM
半角(50%)/FWHM:48.2°
全角(10%)/FWTM:68.4°
光效/Efficiency:78.92%
眩光值/UGR:16.9
灯光颜色/Light colour: 白色/White

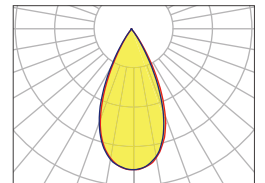

I LENS141-COB28-50-H318M-319M

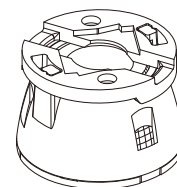
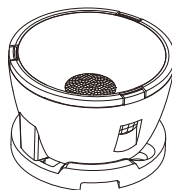
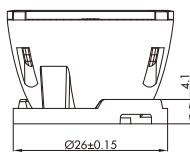
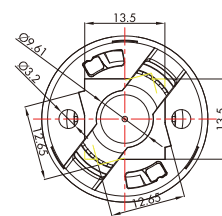
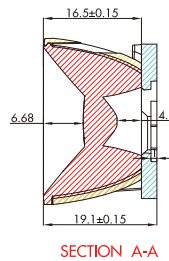
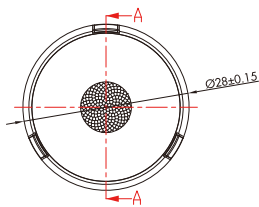

*Holder matched leds/支架匹配光源:

CREE: 13xx
Luminus:CXM-3/CXM-4/CXM-6/CXM-9

Citizen:CLU700/CLU026/CLU027/CLL020
Bridgelux :V3/V4/V6/V8/V4-HD/V6-HD

GENERAL TOL ERANCES ISO2768-M (UNLESS STATED) 一般公差ISO 2768-M(除非另有说明)	MATERIAL 材质	PMMA/PC	注意/NOTE: 1. 镜片表面应光滑无划痕、气泡、凹痕和黑点。 The surface of the lens should be smooth without scratches, bubbles, dents and black spots.	
LINEAR/线性	0~5±0.05		5~10±0.1	10~30±0.15
ANGULAR/角度	0°~10°±1°		10°~50°±0.5°	50°~120°±0.3°

ILENS141-COB28-50-H

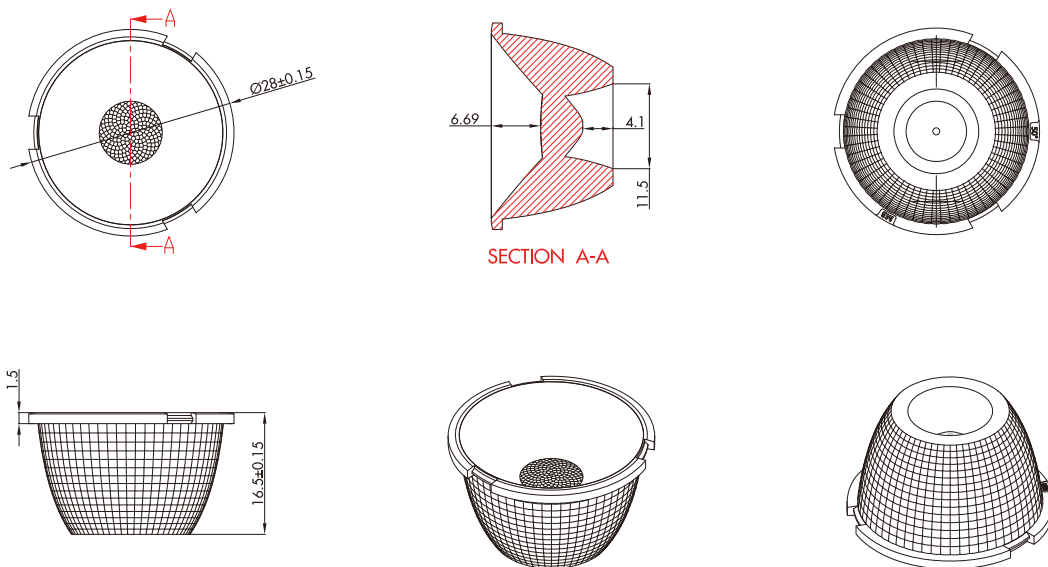

GENERAL TOLERANCES ISO2768-M (UNLESS STATED) 一般公差ISO 2768-M(除非另有说明)	MATERIAL 材质	PMMA	注意/NOTE: 1. 镜片表面应光滑无划痕、气泡、凹痕和黑点。 The surface of the lens should be smooth without scratches, bubbles, dents and black spots.	
LINEAR/线性	0~5±0.05	5~10±0.1	10~30±0.15	
ANGULAR/角度	0°~10°±1°	10°~50°±0.5°	50°~120°±0.3°	

H318M

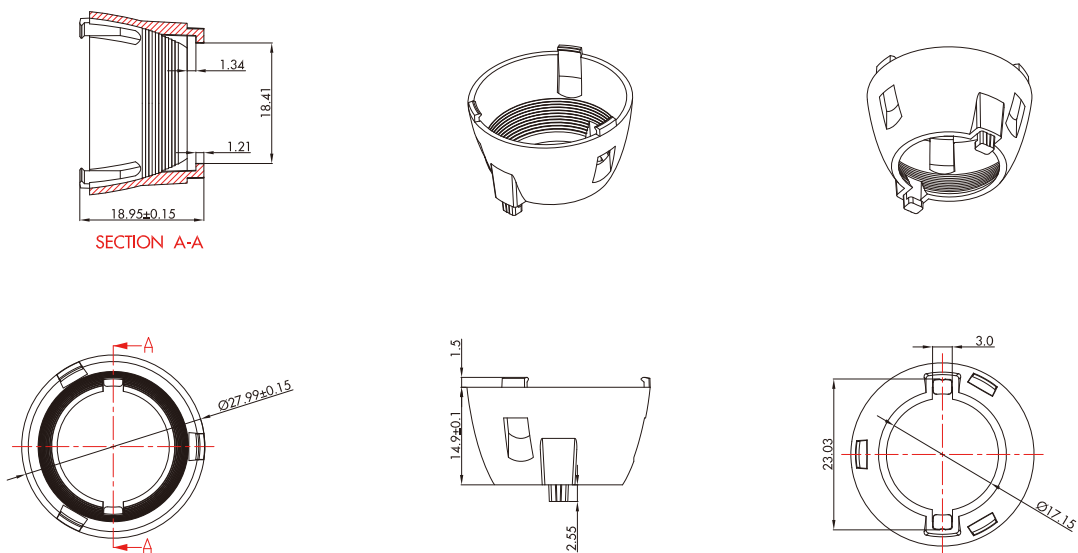

GENERAL TOLERANCES ISO2768-M (UNLESS STATED) 一般公差ISO 2768-M(除非另有说明)	MATERIAL 材质	PC	/	
LINEAR/线性	0~5±0.05	5~10±0.1	10~30±0.15	
ANGULAR/角度	0°~10°±1°	10°~50°±0.5°	50°~120°±0.3°	

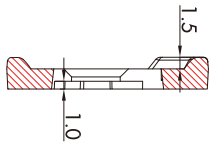

SECTION A-A

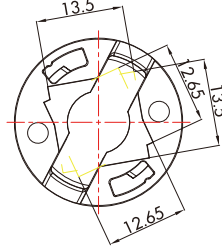
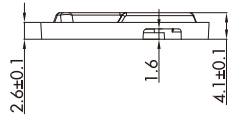
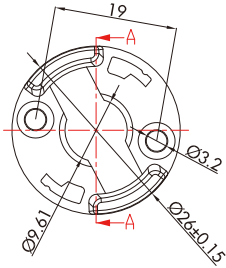
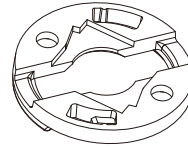
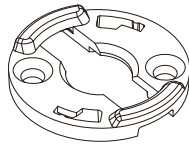

*Holder matched leds/支架匹配光源:

CREE: 13xx

Luminus:CXM-3/CXM-4/CXM-6/CXM-9

Citizen:CLU700/CLU026/CLU027/CLL020

Bridgelux :V3/V4/V6/V8/V4-HD/V6-HD

材质/MATERIAL	PC
线性/LINEAR	
0~5±0.05	
5~10±0.1	
10~30±0.15	
角度/ANGULAR	
0°~10°±1°	
10°~50°±0.5°	
50°~120°±0.3°	

产品包装/Products Packaging

Part NO.	QTY
I LENS141-COB28-50-H	1584pcs
吸塑/Blister-380*300	18pcs
外盒/Cardboard Box-395*312*395	1pcs



I LENS141

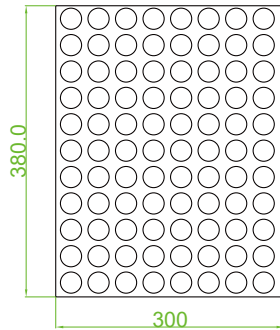

吸塑
Blister-380*300

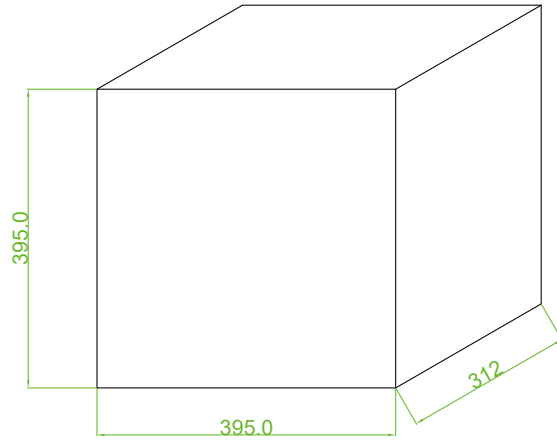

外盒
Cardboard Box-395*312*395

示意图/The schematic diagram:

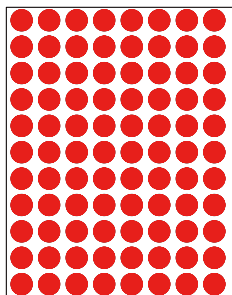

8pcs*11=88pcs

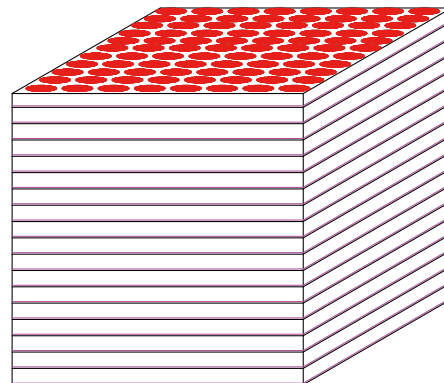

88pcs*18=1584pcs